

ABOUT YOUR HEX LARGE CASE SERIES ELECTRIC SCREEN

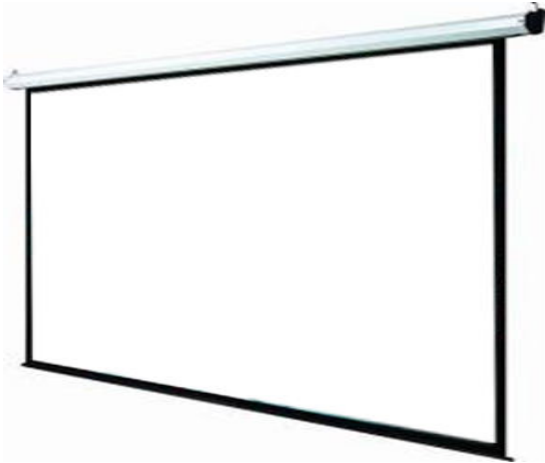

Congratulations on purchase of your SG Audio Visual screen.

The SG Audio Visual HEX Green electric screen features a quality alloy housing and features a premium screen surface a quality tube motor designed for years of worry-free operation.

The SG Audio Visual HEX Large Case Series screens have both a wireless remote control and a wireless wall switch.

This screen comes with a SG Audio Visual 2 years repair or replacement warranty. For more information see the warranty section below.

WARRANTY INFORMATION

Please complete the following information for warranty purposes

Supplier	
Invoice Number	
Date	
Serial Number	

YOUR HEX LARGE CASE SERIES ELECTRIC SCREEN

Before installing your new projector screen please read the instructions carefully and after installation keep these instructions for future reference.

MOUNTING YOUR SCREEN

Your screen may be wall mounted or ceiling mounted using the bracket at each end of the screen.

The screen may also be mounted using optional sliding wall brackets to move the screen out from the wall away from whiteboards, windows, televisions or other potential obstructions. Please see the accessories section for more information.

Please note that where there are very high ceilings it may be better to mount the projector screen on the wall to ensure that the audience can easily see the screen without having to tilt their heads up to see the screen.

Power is required on the left-hand side of the screen (as viewed from the front). A standard power point is required. Please contact a qualified electrician to perform the installation if a power point is required.

The screen comes with basic screws and plastic anchors. A Gyprock™ mounting kit may also be ordered which includes fasteners designed specifically for Gyprock™. Please see the accessories section for more information.

WALL MOUNTING



WARNING - Before drilling any holes please ensure that there are no hidden electrical cables or other obstructions within the wall cavity.

Wall mounting is performed by

1. Carefully measuring and locating the positions of the screws on the wall
2. Drill holes into the wall
3. Insert anchors and screw the screws into the anchor holes, leaving 5mm to hang screen
4. Hang the screen onto the extended screws and then tighten the screws fully.
5. Connect the power cord to power on the left-hand side of the screen.

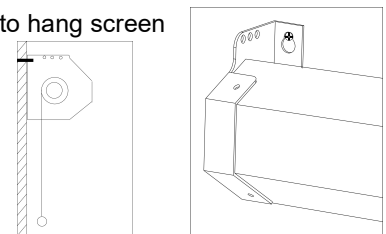
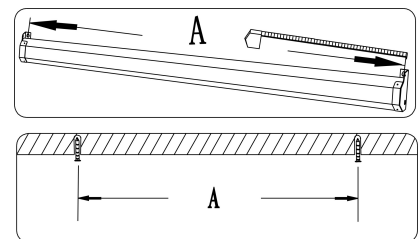

CEILING MOUNTING



WARNING - Before drilling any holes please ensure that there are no hidden electrical cables or other obstructions within the ceiling space. Please note that some ceilings will require additional support to be provided for installation. Please inspect the ceiling carefully prior to installation.

Installation in false ceilings is not recommended without additional support.

Please contact your reseller or support@sgav.com.au for more information.

Ceiling mounting is performed by

1. Carefully measure the distance between the ends of the screen and mark this measurement on the ceiling
2. Drill holes into the ceiling
3. Insert anchors
4. Screw the provided hooks into the plastic anchors and hang the screen.
5. Connect the screen to power on the left-hand side of the screen (when looking at the screen from the front).

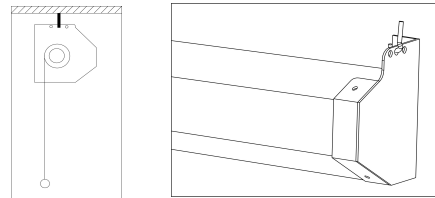
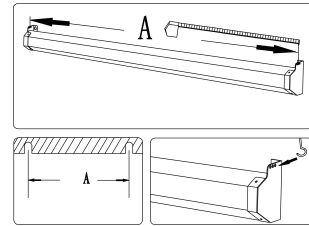

OPERATING YOUR HEX LARGE CASE SERIES SCREEN

Your projector screen may be operated via handheld remote control, wireless wall switch and via WiFi using the Smart Life App.

Additional control options for wired and low voltage control are available separately.

USING THE REMOTE CONTROL

The screen comes with a remote control unit. It is a simple up/down/stop control and comes in a holder which may be wall mounted. Please note that this unit comes with batteries pre-installed.

Note that the remote control unit provided may vary from this picture.



Wireless Remote Control

USING THE WIRELESS WALL SWITCH

The screen comes with a separate wireless wall switch (battery operated) which may be mounted in a convenient location. It comes with up/down and stop buttons.

Note that the wireless wall switch provided may vary from this picture.



Wireless Wall Switch

USING SMARTPHONE APP CONTROL

App control is supported in devices running both Android and IOS Systems

1. Download the "Smart Life" App from the App market, as the right icon shows
2. Register the "Smart Life" App account (this account can be registered according to the region, please pay attention). After completing the registration, log in to the registered account. Please follow the steps below to connect our products:



NOTE: When connecting and pairing the Android / IOS device with your new screen please keep the router and device to be connected as close to each other as possible. If the connection fails please reinstall the App and try connecting the projector screen again.

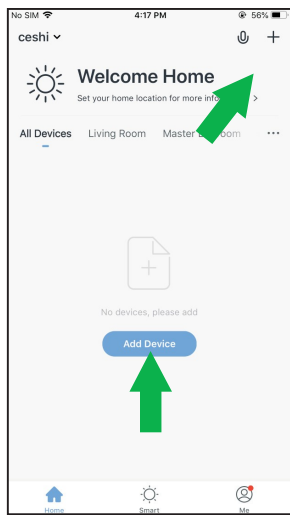

Open the interface after Smart Life App, click Add Device or click the “+” in the upper right corner to enter the next interface

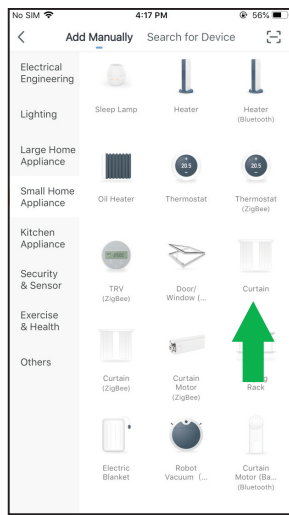

Click to enter this interface, then click on the left “Small Home Appliance” to drop down to find the “Curtain (WiFi)” option, click on the arrow to select

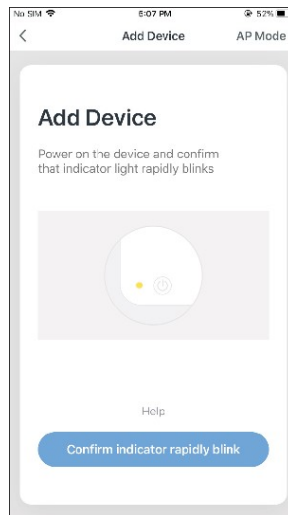

Press and hold the remote control stop button within 10 seconds after power-on, when you hear five “Di” sounds from the screen, reset to enter the pairing state, click to confirm.

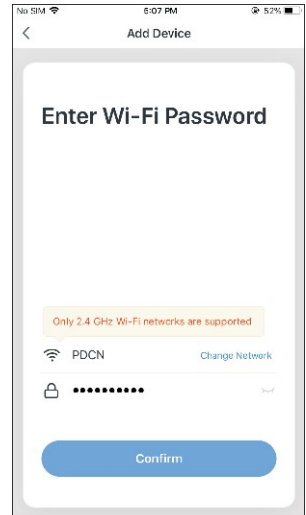

Enter your WIFI account and password, then click confirm

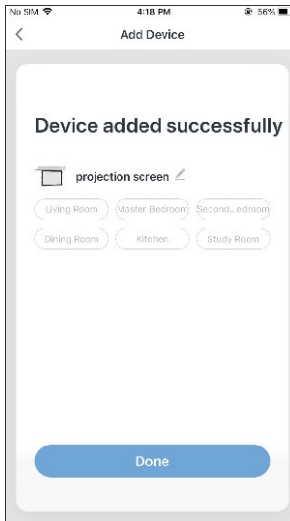

After adding the device successfully, click Done.

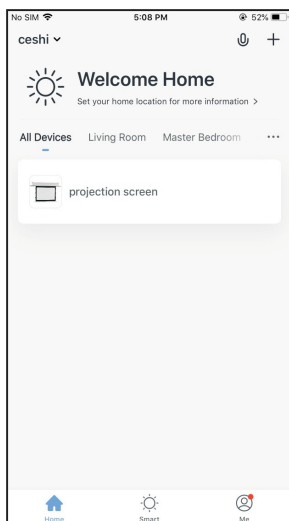

After the completion of the “Smart Life” App interface, click on the “projection screen” to enter the operation interface

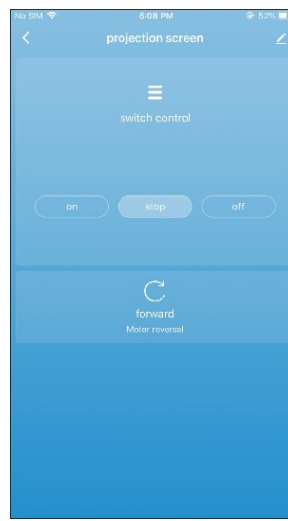

You are now ready to control your screen via the App



To download Smart life screen App Please scan QR code

ADJUSTING THE LENGTH (DROP) AND THE RETRACTED POSITION OF THE SCREEN



Warning – This is a fine adjustment (normally less than one turn). Over-adjustment may damage the screen and make the screen adjustment inoperative. Use the included debugging tool to perform these adjustments.

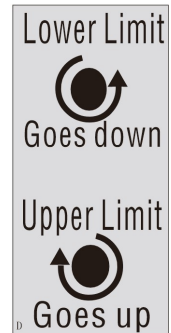

The screen has pre-set limit switches to stop the surface in the up and down positions. In most cases these will be correctly set when shipped.

If necessary, the up and down stop positions are adjustable via limit screws. The holes on the left bottom side of the screen case give access to the limit switches

ADJUSTMENT OF THE DOWN POSITION OF THE SCREEN

This is performed when the screen is slightly too long or too short for the image. This screw is accessible through the screen housing slot, lower the screen till it stops then to:

Lower the screen - Use the included debugging tool or a Number 4 Allen key and turn anti clock-wise no more than one turn to lower the screen surface, raise the screen then lower again and it will be adjusted, repeat until screen is at optimum position.

Raise the Screen - Use the included debugging tool or a Number 4 Allen key and turn clock-wise no more than one turn to raise the screen surface, raise the screen then lower again and it will be adjusted, repeat until screen is at optimum position.



Warning: Never roll down more than 10cm extra screen surface at one time. This can permanently damage the screen

ADJUSTMENT OF THE UP POSITION OF THE SCREEN

This is performed when the screen does not completely retract into the housing or when there is a repeated clicking noise from the screen when the screen is nearly fully retracted.

To bring it closer to housing when fully retracted - Remove plastic cap near the “Up-position Limit Screw”. Use the debugging tool or a Number 4 Allen key and turn anti clock-wise no more than one turn to further roll up the screen surface. Lower and raise screen again to check position and repeat if necessary.

To have it stop further from the housing slot - Remove plastic cap near the “Up-position Limit Screw”. Use the debugging tool or a Number 4 Allen key and turn clock-wise no more than one turn to further roll up the screen surface. Lower and raise screen again to check position and repeat if necessary.

OPTIONS AND SPARE PARTS

HE LARGE CASE SERIES REPLACEMENT PARTS

SG Audio Visual maintain a range of spare parts for your HE Large Case Series screen including replacement motors and control systems.



12V Trigger line



Infrared remote control & receiver



Manual Switch

Alternate low voltage control systems, manual switches and IR control systems are also available.

Please contact your SG Audio Visual reseller for more information or email support@sgav.com.au

WARRANTY UPGRADES

Extended warranties are available for all HE Large Case Series screens.

Please contact your SG Audio Visual reseller for more information or email support@sgav.com.au

MOUNTING OPTIONS

Other related options for your HEX Large Case Series Electric screen include the SG Sliding Wall Mount brackets. These are available in sizes from 23cm to 75cms. Please contact your SG Audio Visual reseller for more information or email support@sgav.com.au



The SG Audio Visual Plasterboard™ kit comprises 4 fasteners optimized for Gyprock™ or Plasterboard™. Please contact your SG Audio Visual reseller for more information or email support@sgav.com.au . Two of these kits are recommended for



the SG Sliding Wall mount brackets.

WARRANTY

The HEX Large Case Series screen comes with a 2 years replacement or repair warranty.

Under this warranty your SG Audio Visual screen will be repaired or replaced solely at the option of SG Audio Visual. The warranty includes manufacturing defects but excludes damage occurring as a result of accident or misuse. Please keep a copy of your sales invoice as proof of purchase.

In event of warranty service being required please email support@sgav.com.au explaining the problem, attaching photos if available and a scanned copy of your tax invoice. If you have standard warranty you will be contacted within 2 working days and a return material authorization number will be issued. Customers with extended warranty will have a replacement screen sent out in accordance with extended warranty terms and conditions.

The faulty screen must be packaged appropriately and returned to the SG Audio Visual repair centre for inspection. The return authorization number must be clearly marked on the outside packaging.

Where screens arrive with a manufacturing fault please contact your SG Audio Visual reseller directly and a replacement screen will be shipped.

CARING FOR YOUR PROJECTOR SCREEN



Always disconnect your screen from power before cleaning.

To make the most of your SG Audio Visual HE Large Case Series screen we recommend cleaning with a soft cloth and lukewarm water. Do not use any detergent or cleaning products. Do not press firmly on the screen surface as you may stretch the surface.

SAFETY AND OTHER WARNINGS

Please read the following as any damage to the screen surface will affect the quality of the picture:

1. Avoid contact or touching the screen surface as it may cause scratches or tears.
2. Do not write or draw on the surface.
3. After disconnecting from power, clean the screen with a soft cloth and lukewarm water. Do not use any detergent or cleaning products.
4. Always disconnect the product from electricity before adjusting or replacing components.
5. Do not use this screen outside or where there is possible exposure to water.
6. Do not open end-caps or dismantle any part of the screen. Only qualified electricians should access internal screen components
7. To prevent unnecessary damage, operation and maintenance of the screen should only be done by adults.
8. Only use original parts.
9. Product specifications are subject to change without notice

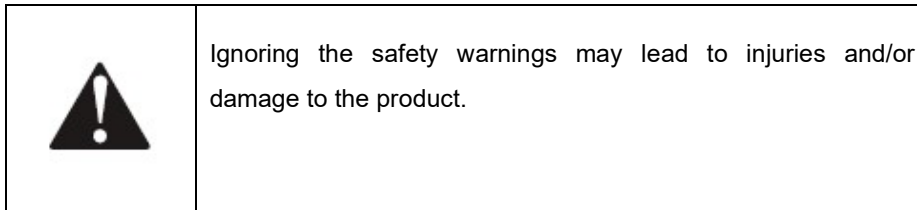

If there are any problems, please contact your local SG Audio Visual dealer or support@sgav.com.au.