

RF+IR204 Radio Receiver Manual

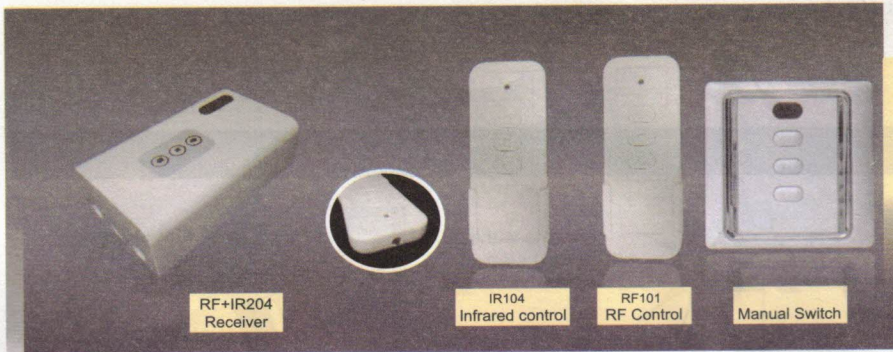

1. Features

- Work with all electric screens.
- SMT machine automatical assembly, damp proof craft
- Support of IR,RF,Manual control and DC12V trigger
- Work with motorized projection screen, motorized awning, roller blinds etc

2. Parameters

Model No.	Voltage	Temperature	Receive distance	Loading Power	Frequency	Operation Mode
RF+IR204	230VAC 50Hz	-40℃ +85℃	RF ≥ 80M IR ≥ 8M	≤300W	RF 433.92HZ IR 38KHZ	RF, IR and Manual control, DV12V trigger

Warning



Power off before wiring



Avoid static damage



Earth wire must be connected well and correctly



Not touching with metal in avoiding interference

3. Wiring

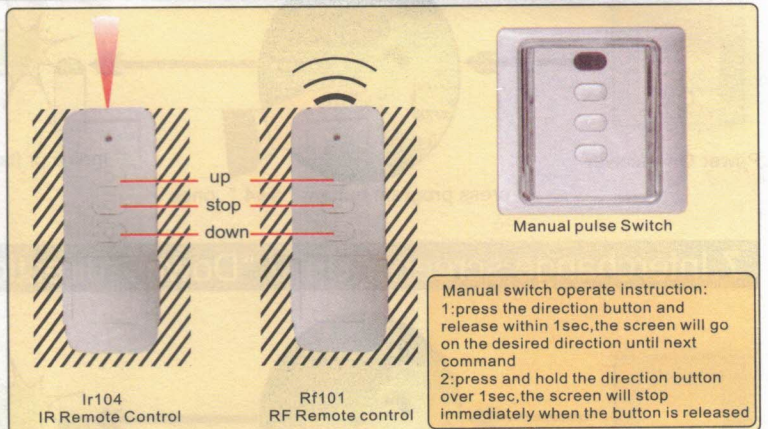
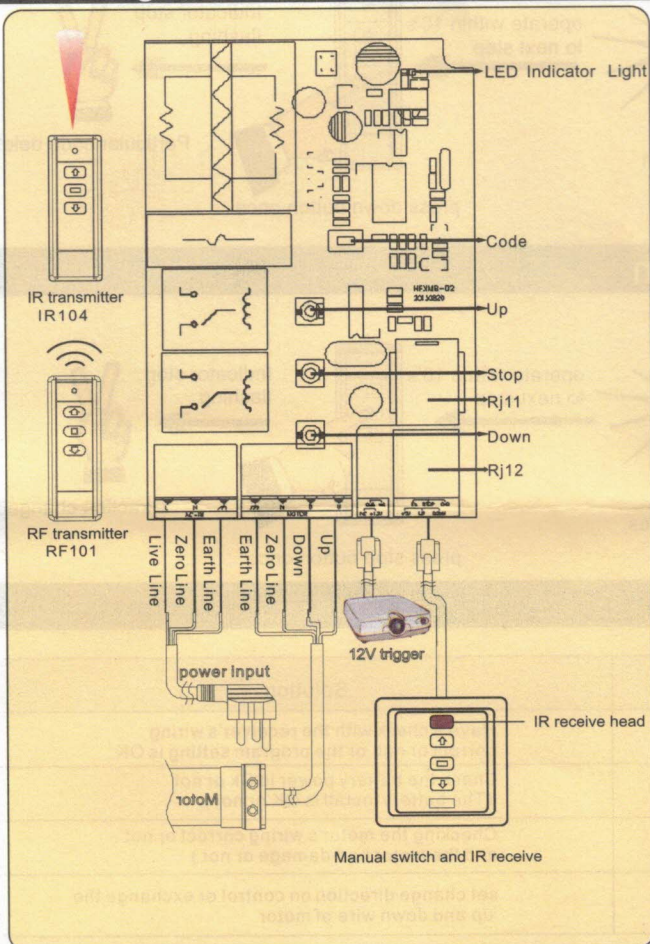

Wiring

Motor wiring terminal

E: Earth (Green/Yellow)
N: Neutral (Blue)
L: UP/Down (Black)
R: Down/UP (Brown)

Power wiring terminal

N: Neutral (Blue)
E: Earth (Yellow/Green)
L: Live (Brown)

12V trigger terminal

NC: empty terminal
GND: earth wire
+12V: DC trigger

Manual switch wiring terminal

+5V: IR voltage	S: stop (green)
IR: IR signal	D: Down/up (black)
U: UP/DOWN (brown)	G: Neutral (BLUE)

Function Adjustment

- ①Receiver would come back the original state if there are not any operations within 10's.
- ②Upto total 20 RF transmitters can be programmed with 1 receiver
- ③The longest working time of screen is 5 minutes

4. RF coding

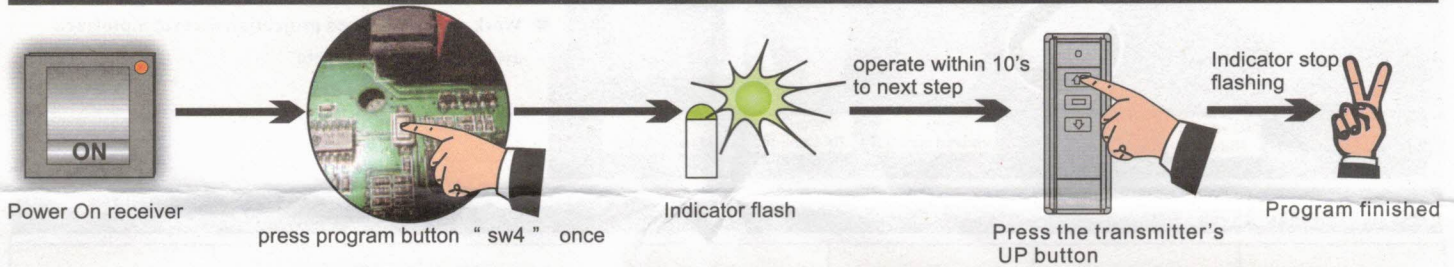

5. Delete all codes on receiver

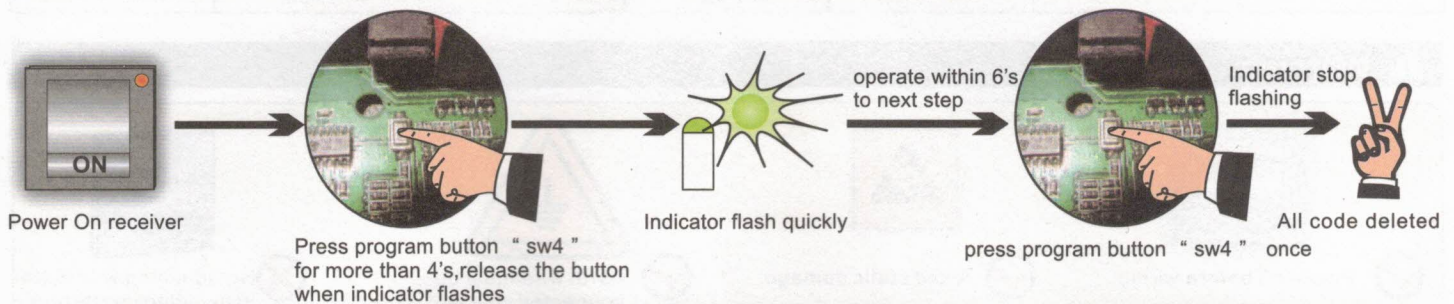

6. Delete particular code between receiver and transmitter

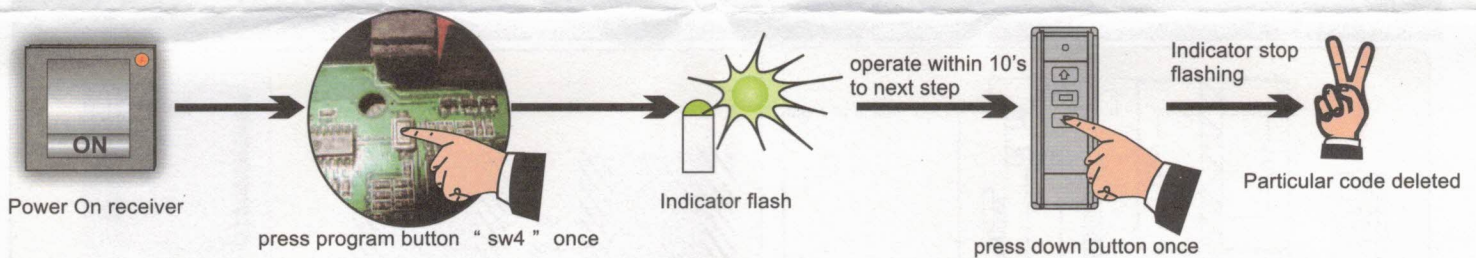

7. Interchange screen "Up" / "Down" direction

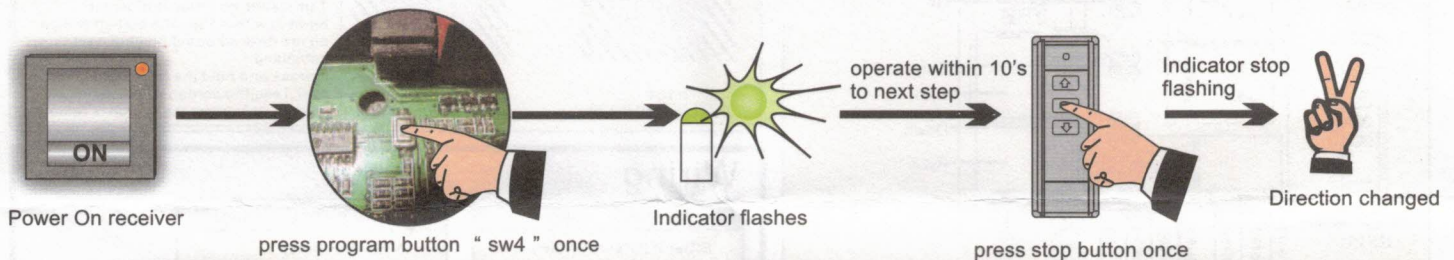

8. Trouble shooting

Items	Symptom	Solution
1	When operate, the transmitter's LED1 work well, and the receiver doesn't action	Have a check with the receiver's wiring correct or not, or the program setting is OK
2	The transmitter's LED isn't bright or dark bright	Check the battery power is Ok or not (The battery install is OK or not)
3	The control system work well, but the motor is out of working	Checking the motor's wiring correct or not, and the motor had damage or not)
4	Press up key, motor run down, press down key, motor run up	set change direction on control or exchange the up and down wire of motor