

Epson EB-PU2010BNL



[+ ENLARGE IMAGE](#)

Installation Multimedia Projectors

Take Image Quality to New Levels with Epson's Game Changing Laser Projector

[Distance Calculator](#)

[Printer Friendly Specs](#)

[Where to Buy](#)

Overview

KEY FEATURES & BENEFITS

- NEW** Up to 10,000 lumens – deliver captivating images in virtually any venue
- Laser light source – experience astonishing quality and reliability
- Up to 3x brighter colours, and reliable performance¹ – 3LCD, 3-chip technology
- 2,500,000:1 contrast ratio – for lifelike images and remarkable detail in dark scenes
- 4K enhancement - go beyond high definition with 4K enhancement and native WUXGA (1920 x 1200) resolution for presentations, videos, digital signage and more
- NEW** High dynamic range - faithfully reproduce HDR content for an exceptional visual performance
- NEW** Gamma correction – automatically adjusts the image based on scene images frame by frame for optimum contrast
- NEW** NFC feature & **NEW** Epson Configuration Tool App – collect essential projector information by simply tapping a mobile phone on the back of projector
- NEW** High-performance options – external high capacity air filter ELPAP63 and light weight ceiling mount ELPMB67 and extension pole ELPFP15
- NEW** External camera – ELPEC01 automatically calibrates image with Epson Professional Tool software
- NEW** SDI in & out – daisy chain ability allows the simplest stacking without requiring an additional PC or a splitter (SDI connectivity is only available on EB-PU2010B/W)
- NEW** Art-Net support – synchronise image brightness with the stage and theatre lighting effects.
- Professional tool - efficiently setup multiple projectors straight out of the box with new large venue application software
- Colour uniformity - keep images consistent and maintenance to a minimum with automatic colour correction (automatic calibration is supported only with ELPEC01)
- Edge blending - combine multiple individual images to create one seamless giant image
- Wireless LAN Enterprise Security - connect projectors in a secure wireless network environment
- HDBaseT - transmit full HD video and audio, Ethernet and Serial communication through a single CAT 5/6 cable that can be extended up to 100m
- 360° installation - install on any plane, from horizontal to vertical and everything in-between
- Powered lens shift, zoom and focus - project perfectly uniform images with a new stepping motor and store up to 10 lens settings
- Eleven optional lenses² - choose the ideal powered lens for your venue from a wide range including ultra-short throw and long throw
- Content playback - create engaging digital experiences with Epson content management software and playback contents saved on USB drive.
- 5 year projector warranty³ - A class leading 20,000 hour or 5 year warranty

¹ Colour brightness (colour light output) in brightest mode, measured by a third-party lab in accordance with IDMS 15.4. colour brightness will vary depending on usage conditions. Top-selling Epson 3LCD projectors versus top-selling 1-chip DLP projectors based on NPD sales data for October 2019 through September 2020.

² Please refer to lens compatibility chart

³ Whichever occurs first, see www.epson.com.au for full warranty terms and conditions.

HIGH IMAGE QUALITY

3LCD technology

All Epson projectors are based on 3-chip LCD technology for amazing colour, incredible detail and solid reliability. 3LCD's 3-chip architecture dedicates an entire chip to process each primary colour – red, green and blue, continuously. Unlike single-chip technology that delivers colour sequentially, you get full-time colour. The result is vibrant, realistic images and video all delivered with 3LCD's true-to-life colour.

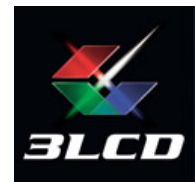

Up to 3x brighter colours with Epson projectors*
Epson projectors use 3LCD engines that have no colour wheel with a white segment and therefore don't force a tradeoff between white and colour brightness.

In fact, Epson projectors have up to 3x brighter colours than their leading competitive 1-chip DLP projectors*. All Epson projectors list both white brightness and colour brightness specifications, and all have high colour brightness.

* Colour brightness (colour light output) in brightest mode, measured by a third-party lab in accordance with IDMS 15.4. colour brightness will vary depending on usage conditions. Top-selling Epson 3LCD projectors versus top-selling 1-chip DLP projectors based on NPD sales data for October 2019 through September 2020.

Laser light source

Experience astonishing quality and reliability with Epson's new laser light source. The newly designed laser light source and advanced electrostatic filter deliver 20,000 hours of maintenance-free use and consistent performance for total peace of mind during important presentations



NEW Up to 10,000 lumens

Powered by 3LCD technology and Epson's laser optical engine, the EB-PU2010B is capable of producing white light and colour light output of up to 10,000 lumens in WUXGA resolution, delivering captivating images in virtually any venue.

The laser light source also lets you take control of brightness with precise adjustment in increments of 1% and a constant brightness mode that maintains brightness at a specified level



4K enhancement

The EB-PU2010B delivers high-precision images with 4K enhancement (4KE) technology. Upscale 1080p content with 4KE, which shifts pixels diagonally by 0.5 pixels to double the resolution, for crisp and high-definition images.

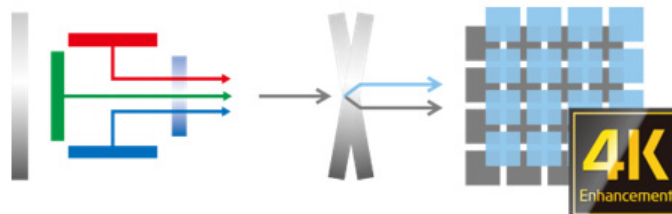

Deep black contrast

The EB-PU2010B delivers deep black contrast ratios up to 2,500,000:1. With Epson's innovative laser light source, you get remarkably high contrast levels during full-black scenes. A special optical device is used to adjust polarization and reproduce truly dark shades of black for projection venues that require the most deep black such as theatres.



NEW High dynamic range

The EB-PU2010B supports HDR10 and Hybrid Log-Gamma, which expands dynamic range for image output across a broad tonal range and minimises washed-out highlights or excessive shadow in dark areas.

SDR (standard dynamic range)



HDR (high dynamic range)



NEW Scene adaptive gamma correction

Gamma level is adjusted automatically according to the content image frame-by-frame, projecting the optimum contrast level. By controlling crushed blacks in dark scenes and clipped whites in bright scenes, images can be displayed in the most natural and life-like manner.



ADVANCED INSTALLATION FEATURES

Powerful and compact

The EB-PU2010B can deliver upto 10,000 lumens of brightness in a compact size*. Approximately 25% smaller and lighter than Epson's L series projectors, transporting and setup process has become much easier, and loading weight has become much lighter when projectors get shipped to shows and events.

*Weight: 16.8kg (excluding lens), Dimension D x W x H: 436 x 545 x 164mm (excluding lens, cable cover and feet)

**25% smaller
and lighter***
than the traditional model



Powered lens shift, zoom and focus

The motorised lens shift covers a wide range, giving you a great deal of flexibility when installing the projector. A newly adopted stepping motor lets you make highly precise adjustments when employing edge blending, stacking and other techniques. Adjustments can be made via remote control or over a network, enhancing usability even for ceiling-mounted projectors.

*±67% vertically, ±30% horizontally for EB-PU1000 series with ELPLM08

*±60% vertically, ±18% horizontally for EB-PU2000 series with ELPLM15

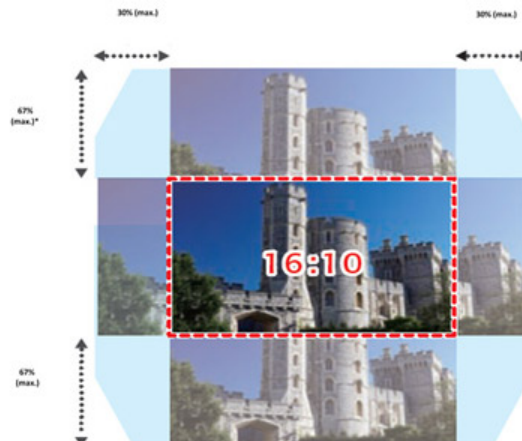

NEW SDI in/out signal

The EB-PU2000 series is equipped with SDI (in/out) signal*, stacking of two projectors can be done without requirement of PC or Wi-Fi router. Conveniently project up to 20,000 lumens of brightness with two EB-PU2000 series in large venues using the built-in daisy chain function‡. Simply connect two projectors with a LAN cable and trigger the function with remote command to setup within 7 minutes**.

*SDI in & out connectivity is only available on EB-PU2010B and EB-PU2010B. ‡Daisy chain function is limited to connecting 2 projectors only. **ELPEC01 external camera is required to achieve installation within 7 minutes. Combining with EPPT software, automatic stacking process reduces setup time to 5 minutes.

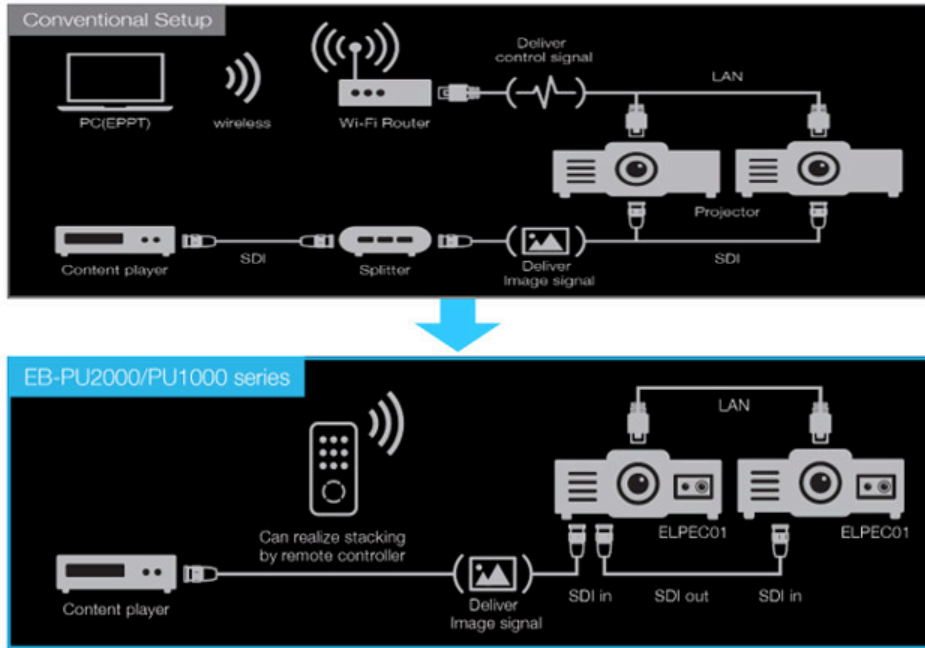

Multi-directional projection

The EB-PU2010B can be rotated 360° in any direction — horizontally, vertically and diagonally — ideal for a wide range of applications, such as ceiling or floor projection.

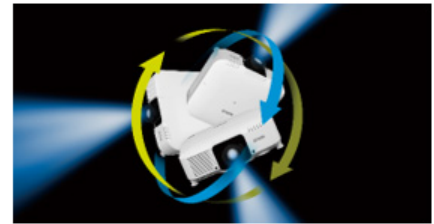

Lens position memory

Up to 10 settings can be stored in the projector memory, including shift positions, focus and projection sizes.

Scaling

Make the most of the image content's native aspect ratio using a scaling feature built-in to the EB-PU2010B. Without requiring a supercomputer, source content from a splitter output can be recombined automatically using the scaling feature of two projectors.

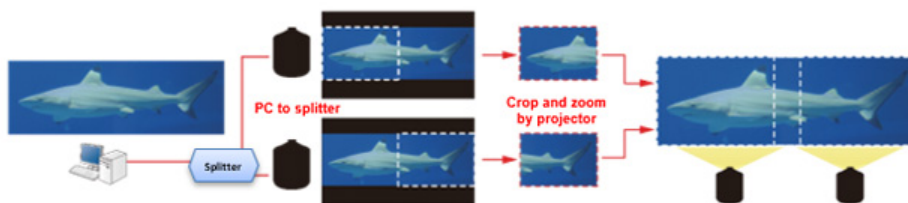

NEW Art-Net lighting control system

The EB-PU2010B supports Art-Net lighting control systems, making the projector ideal for use in live performances in stage or theatre. Control the projector with an Art-Net compatible lighting desk or control system to synchronise with in-house lighting effects. Image brightness can be controlled as low as 8% to the maximum 100%, giving ultimate fade-in and fade-out effects for stage and theatre shows and performances..

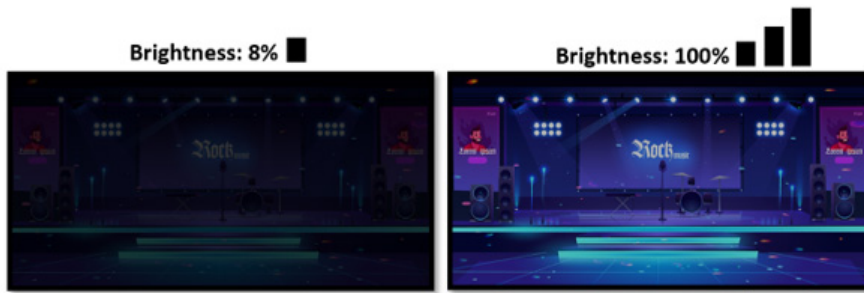

Incredible HDBaseT and diverse connectivity
 Connect with virtually any system including HDBaseT, SDI, DVI-D, HDMI, VGA, BNC and LAN connectivity. Cutting-edge HDBaseT technology means just one single CAT-5/6 cable carries Full HD video, audio, network and control commands up to 100 meters to accommodate large venues. No need for additional cables, signal repeaters or added labour

ADVANCED BUILT-IN FUCTIONS

NEW NFC technology

Shorten kitting time with Epson Projector Config Tool App* & NFC function. Customisation of settings of the EB-PU2010B projector can be done up to 100 units as a batch. Specifically designed for rental and stage, SI and IT managers, the projector's inventory data can be easily checked and collected instantaneously by simply tapping with a mobile phone without having to turn on the projector.

**Epson Projector Config Tool App is available on iOS11 and Android 8.0*



Edge blending

Enhance the experience with seamless panoramic, multi-screen images that blend edges by matching colour and brightness perfectly, even in areas that overlap.



Point correction

Make smooth adjustments of distorted projection images by shifting each of the points laid out on the grid pattern.



Arc correction

Using arc correction, you can adjust each side of a projected image in an arch or barrel-shaped way, making it easier than ever to get a perfectly rectangular image.

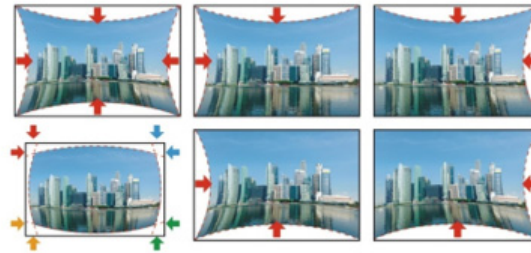

Colour uniformity

Keep images consistent and maintain images that have become uneven over time between multiple projectors with manual colour correction function.

Corner wall and curved surface projection

Quickly and precisely correct any vertical or horizontal image distortion with Epson's curved surface and corner wall projection. These features allow for greater flexibility when choosing a projection surface. Enhance your viewers experience by projecting your content in a unique environment with ease.



Content playback

The EB-PU2010B projector has an in-built content playback feature, allowing you to save videos and photos to USB flash memory and project them instantly without the need for a PC. Epson's dedicated software for digital signage applications complements the embedded feature for a cost-effective solution.



For instant content creation, the Epson Creative Projection App is available on iOS devices.



For scheduling, the Epson Content Management software is available for planning and execution.

ADVANCED INSTALLATION SOFTWARE

Epson Projector Professional tool

Setup multiple projectors straight out of the box with new large venue application software. Epson Professional tool allows you to adjust and control images projected on a network with high-end projector setup features such as colour uniformity calibration, geometry correction, image layout adjustment, lens control and edge blending. Exclusively bundled to Epson laser projectors, large scale presenting has become much easier and flexible with automation.

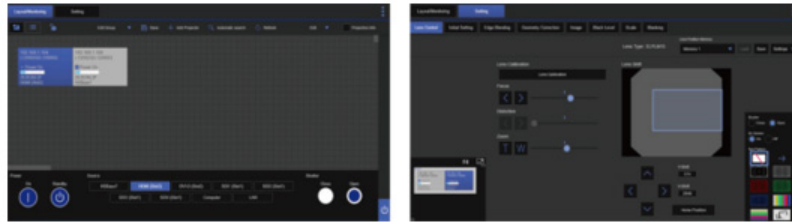
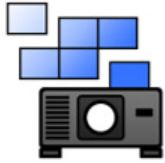

NEW Epson Projector Professional Tool x ELPEC01 support

Pair an ELPEC01 external camera with an EB-PU2010B projector to enable automation for geometry correction and screen matching. Powered by Epson Projector Professional Tool software, the set up for tiling and stacking of multiple projectors is quicker and easier than ever before.



EB-PU2000/1000 series with ELPEC01 lens attached

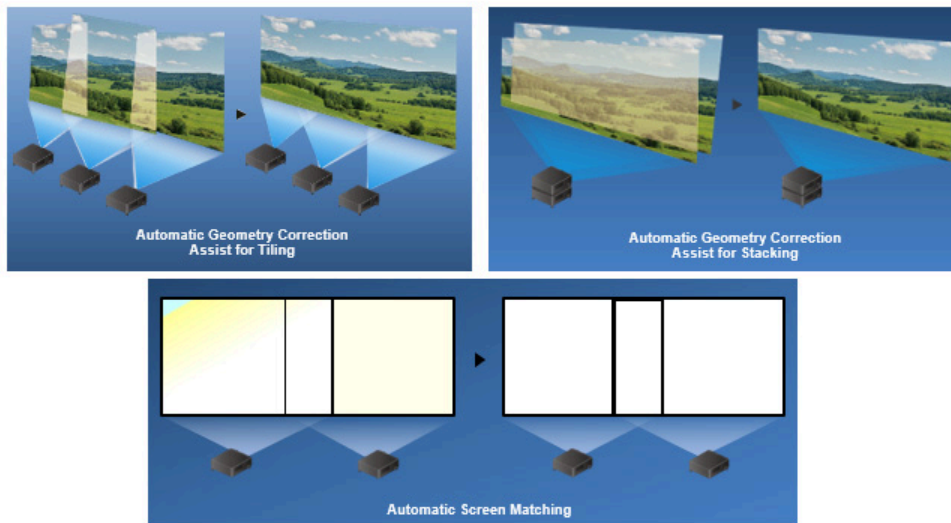

NEW Epson Projector Config Tool App

Exclusively available with the EB-PU2010B, Epson Projector Config Tool App* can save time on communication. Powered by NFC technology, projector information can be imported, exported for kitting preparation and confirmation. Installers, SI specialist, end customer, service team, repair team and rental & stage operators can now save time and effort, requiring as little as 7 minutes to collect the data out in the field on an iOS or Android device.

*Epson Projector Config Tool App is available on iOS11 and Android 8.0



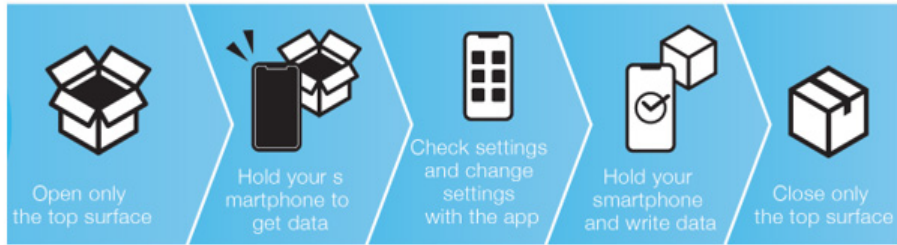

Epson Creative Projection App

With Epson Creative Projection app, you can create original, dazzling content to enliven rooms, product displays, and spaces around you, anytime and anywhere. Available on iOS devices, such as iPhone and iPad, content can be previewed while projecting and editing content at the same time. With extensive preloaded templates, freely arrange and combine materials in the app any way you like. From simply uploading photos and movies from a mobile device to making animated visual effects, instantly make your display content come to life without requiring a PC.

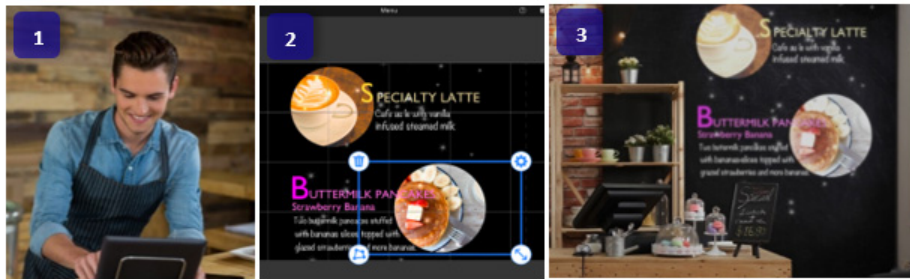

Epson Content Management software

With Epson Content Management software, you can easily create playlists for signage content from a PC or a laptop. The ability to set schedules and register the shape filter settings gives you advanced control such as synchronised playback.

Key features of the software include:

- Creating playlists
- Adding visual effects
- Setting up remote shortcuts
- Applying custom filters
- Scheduling playlists



DICOM Simulation Mode

DICOM (Digital Imaging and Communication in Medicine) is a standard for handling, storing, printing and transmitting medical imaging information. The projector's DICOM Simulation Mode enables users to reproduce images with an advanced grayscale level that simulates DICOM Part 14. This mode is ideal for viewing grayscale medical images, such as X-rays, for training and educational purposes.

Collaborative Presenting - iProjection software

Multiple users can connect simultaneously to one projector using Epson iProjection software which allows you to display four individual PC screens simultaneously over the network (wired or wireless), with up to 50 users connected to the same projector. This feature is a great tool for meetings or classroom projects where multiple users want to present and compare their screens.



Simple acontrol – Epson Projector Management software

Using arc correction, you can adjust each side of a projected image in an arch or barrel-shaped way, making it easier than ever to get a perfectly rectangular image.

Use features such as Epson Projector Management software to monitor and control projectors, with fleet control across a network or on a web browser to keep track of up to 2,000 projectors. The latest models feature a newly designed OSD Control Pad function that shows a representation of lens conditions on a smart device.

ADVANCED INSTALLATION SOFTWARE

Ultra-short throw lens

The ELPX01S is a UST lens can produce images from 100 inches to a massive 1,000 inches at a throw distance of 0.74m – 3.1m respectively and has a lens shift of +17% vertically and ±10% horizontally for added flexibility. The UST lens is also available in white.

(EB-PU2010B/W model is compatible with ELPX02S. Lens shift range of ELPX02S: +20% vertically, ±15% horizontally. Please refer to lens compatibility chart)

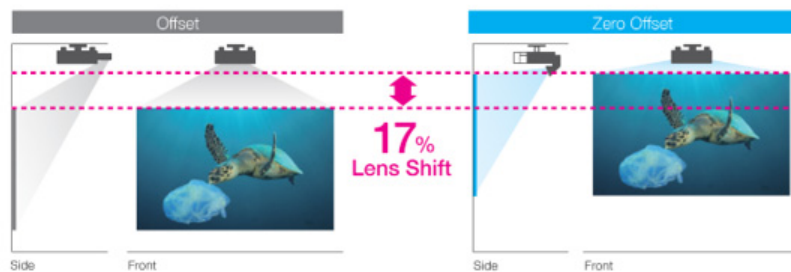

Eleven optional lenses

For added flexibility, the EB-PU2010B offers a total of eleven lenses, including middle, wide, long, short and ultra-short throw that allow users to choose the lens most suited for their environment. A quick-release lever allows for a fast, easy lens exchange

4K ready optional lens

A wide range of optional lenses are available for the EB-PU2010B to support any installation scenario. The optional lenses are all 4K compatible, and combined with the projector, deliver focused and sharp 4K enhanced images.

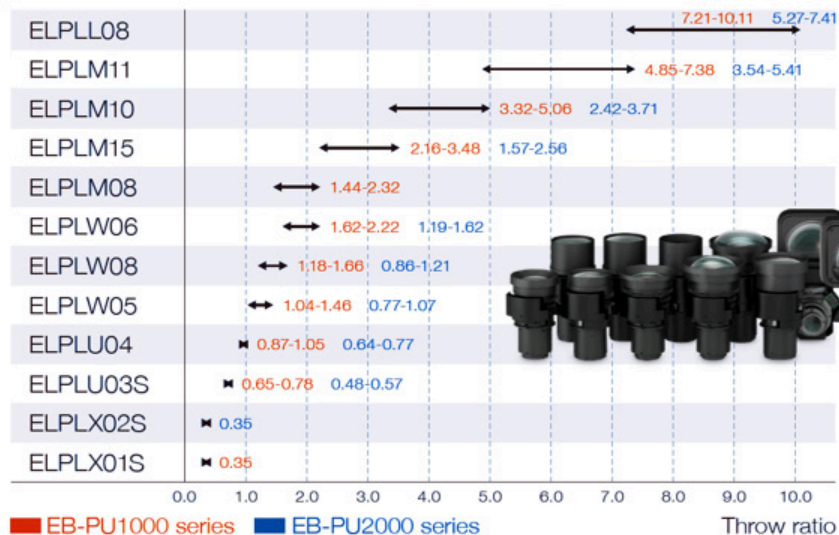

NEW Ceiling mount ELPMB67 and extension pole ELPP15

ELPMB67 ceiling mount and ELPP15 extension pole are lighter than the previous mount, giving you even more installation flexibility across the Epson laser projectors. Also, the ELPMB67 can accommodate wider vertical adjustment angle within + 5° / -15° range. Both mount and extension pole come in grey to easily integrate into any colour scheme.

The ELPWP10 allows content to be displayed from four different devices simultaneously, making content sharing a seamless experience.



ELPMB67 + ELPPFP15



ELPMB67



ELPMB67 + ELPPFP15



ELPEC01

NEW External camera ELPEC01

Attach an ELPEC01 external camera to the EB-PU2010B or ELPLX01 UST lens to enable a powerful installation capability. Compatible with Epson Professional Tool software and Epson Projector Management software, automate manual installation processes and enable remote camera access when required



ELPEC01 with projector



ELPEC01 with UST lens

NEW External air filter ELPAF63

Exclusively designed for the EB-PU2010B, external air filter ELPAF63 extends the brightness level and protects the projector's internal optical engine from external dust particles. Attaching the ELPAF63 gives an equivalent protection to sealing an optical engine structure, so that the projector's performance is not compromised in an environment that contains high degree of particulates

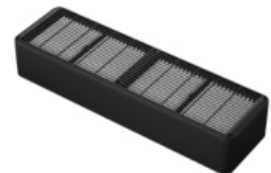

ELPAF63



ELPAF63 with projector

Connectivity panel



Specification

PRODUCT NAME	EB-PU2010BNL
PRODUCT CODE	V11HA52853BU
TECHNOLOGY	
Projection System	3LCD
LCD Panel	1.0-inch
What's in the Box	EB-PU2010BNL Projector, 3m 10A Power Cable, Quick Start Guide, Remote Control, 2 x AA Batteries, Cable Cover, Lens connector cap, Registration Card
IMAGE	
Light Source	Laser Diode
Resolution	WUXGA
Colour Light Output	10,000 Lumens
White Light Output	10,000 Lumens
Native Aspect Ratio	16:10
Contrast Ratio	2,500,000:1
LD Input Power	388 W
Referenced Standard Lens	ELPLM15
Keystone Correction (Standard Lens)	Vertical: $\pm 45^\circ$ Horizontal $\pm 30^\circ$
Lens Shift (Standard Lens)	Vertical: $\pm 60^\circ$ Horizontal $\pm 18^\circ$
OPTICAL	
Zoom	1 - 1.6 (Optical)
Screen Size (Standard Lens)	60" to 1000"
Projection Distance (Standard Lens)	100" screen 3.38 m – 5.52 m
Throw Ratio	1.57 (Zoom:Wide) 2.56 (Zoom:Tele)
Projection Lens F Number	1.8 – 2.3
Projection Lens Focal Length	36 mm – 57.35 mm
Focus Method	Powered
CONNECTIVITY	
Input: Video	-
Input: Computer	1 x D-sub 15-Pin (RGB)
Input: Digital	1 x HDMI, 1 x DVI-D, 1 x HDBaseT, 1 x BNC (SDI)
Input: SDI	1 x BNC
Input: Audio	-
Control: I/O	1 x RS-232C, 1 x Stereo mini
Network: I/O	1 x RJ45, 1 x USB Type A (for Optional Wireless LAN)
HDBaseT	Yes
Wireless Connectivity	Optional
Output: Video	-
Output: Digital	1 x BNC (SDI)
Output: Audio	1 x Stereo mini
ADVANCED FEATURES	

EPSON Projector Management (Network & Control)	Yes
EPSON iProjection (Multi-PC Projection)	Yes
EPSON Professional Tool	Yes
Remote Access Camera	Optional ELPEC01
External Air Filter (High capacity)	Optional ELPAF63
Wireless LAN Enterprise Security	Yes (with Optional Wireless LAN Unit)
4K Enhancement	Yes
Fully Sealed Optical Engine	–
Interchangeable Interfaces	–
Art-Net	Yes
Lens Position Memory	Yes (10 positions)
Split Screen	Yes
Edge Blending	Yes
Curved Screen Projection	Yes
Corner Wall Projection	Yes
Frame Interpolation	Yes
Super Resolution	Yes
Detail Enhancement	Yes
360 Degree Projection	Yes
Content Playback	Yes
Instant Off	Yes
Direct Power On	Yes
Security	Kensington®-style lock provision Wireless LAN Unit Lock Security cable hole
Colour Modes	Dynamic Presentation Cinema BT.709 Natural DICOM SIM Multi-Projection

GENERAL

Dimensions D x W x H (Including Feet)	436 x 545 x 189 mm
Weight	17.0 Kg
Projector Warranty*	5 years
Power Consumption: LD On	452 W
Power Consumption: Standby	2.0 W
Noise Level (Normal/Eco)	37 / 30 dB

COMPATIBLE LENS

ELPLX01	–
ELPLX02	Yes
ELPLU03	Yes
ELPLU03S	Yes
ELPLU04	Yes
ELPLW05	Yes
ELPLW08	Yes
ELPLW06	Yes
ELPLM08	–
ELPLM15	Yes
ELPLM10	Yes
ELPLM11	Yes
ELPLL08	Yes

*20,000 hours or 5 year warranty (whichever comes first)

Epson is the registered trademark of Seiko Epson Corporation. Epson ESC/P2 and Epson Stylus are trademarks of Seiko Epson Corporation. MicroDot is a trademark of Epson Australia Pty Limited. All other product names and other company names used herein are for identification purposes only and may be the trademarks or registered trademarks of their respective owners. Epson disclaims any and all rights in those marks. Specifications are subject to change without notice.

Equipment supplied by Epson Australia is designed to function in conjunction with genuine Epson consumables and accessories specifically configured for it.

Usage Conditions

Epson products are designed and manufactured to be highly reliable and last a long time when used according to their specifications. With any system, product or device used in situations where human life may be involved or at risk, Epson advises that you should take all necessary steps to ensure the suitability of your Epson product for inclusion in your system, and recommends that you include fail-safe procedures and redundancy support or backup equipment in your system, to maintain the maximum safety margin and optimum system reliability. Examples include but are not limited to - do not interfere with any electrical components within the device, do not use items supplied with the product for purposes other than as intended by Epson (e.g. power cords, inks, CDs, plastic wrapping) and do not make modifications to the product.

Consumables

ACCESSORIES & OPTIONS	PRODUCT CODE
<u>ELPAP11 Wireless LAN Unit</u>	V12H005A01
<u>ELPLM15 Middle Throw Lens</u>	V12H004M0F
<u>ELPLL08 Long Throw Lens</u>	V12H004L08
<u>ELPLM10 Middle Throw Lens 3</u>	V12H004M0A
<u>ELPLM11 Middle Throw Lens 4</u>	V12H004M0B
<u>ELPLU04 Short Throw Lens 2</u>	V12H004U04
<u>ELPLU03S Short Throw Lens 1</u>	V12H004UA3
<u>ELPLW05 Wide Throw Lens 1</u>	V12H004W05
<u>ELPLW06 Wide Throw Lens 2</u>	V12H004W06
<u>HDBaseT Transmitter</u>	V12H547053
<u>ELPAF46 Replacement Filter</u>	V13H134A46
<u>ELPAF63 External Air filter</u>	V13H134AD0
<u>ELPMB67 Ceiling Mount</u>	V12HA54010
<u>ELFPF15 Extension Pole 460 – 680 mm</u>	V12HA55010
<u>ELPLX02S Ultra Short Throw Lens</u>	V12H004X0B

Epson is the registered trademark of Seiko Epson Corporation. Epson STYLUS, PerfectPicture, MicroPiezo, AcuPhoto Halftoning, QuickDry are the trademarks of Seiko Epson Corporation. All other names and company names used herein are for identification purpose only and may be the trademarks or registered trademarks of their respective owners. Epson disclaims any and all rights in those marks. All print samples shown herein are imulations. Specifications are subject to change without notice.